



KNOWLEDGE BUILDING • KNOWLEDGE TRANSFER • IMPLEMENTATION

# National Child Welfare Evaluation Summit

## PROGRAM AGENDA

MAY 27 – 29, 2009

RENAISSANCE MAYFLOWER HOTEL  
WASHINGTON, D.C.



Sponsored by the Children's Bureau  
Administration for Children and Families

# ACKNOWLEDGEMENTS

The development and planning of the National Child Welfare Evaluation Summit demanded significant collaboration, support and effort. Many thanks to all the individuals, staff and Federal partners who made this event possible, with special thanks to:

## **Research and Evaluation Workgroup, Children's Bureau**

**Bronia E. Ashford**, Region II

**David Baker**, Division of State Systems

**Brian Deakins**, Capacity Building Division

**Sally Flanzer**, Region IX

**John Henderson**, Region X

**Sylvia Kim**, Child and Family Services Review Team

**Bethany D. Miller**, Division of Research and Innovation, Co-Chair

**Sharon Newburg-Rinn**, Data and Technology Team

**Jean F. Nussbaum**, Office on Child Abuse and Neglect, Co-Chair

**Heather Swope**, Data and Technology Team

**Krista Thomas**, Region V

**Miguel Vieyra**, Division of Program Implementation

**Misty Will**, Child and Family Services Review Team

**Joseph J. Bock**, Acting Associate Commissioner, Children's Bureau

## **Division Directors, Children's Bureau**

**O. Jane Morgan**, Director, Division of Child Welfare Capacity Building

**Catherine M. Nolan**, Director, Office on Child Abuse and Neglect

**Janice P. Shafer**, Director, Division of Research and Innovation

**Elaine Voces Stedt**, Federal Project Officer, Children's Bureau

## **Office of the Assistant Secretary for Planning and Evaluation (ASPE)**

### **Office of Planning Research and Evaluation (OPRE)**

### **Planning and Learning Technologies (Pal-Tech), Inc.**

**Dorothy V. Harris**, Senior Vice President for Special Projects on Children, Youth, and Families

**Melissa Askins**, Administrative Assistant

**Donna M. Rawls**, Project Manager

**Ariel L. Walker**, Conference Support Specialist

**Shelly Wood**, Senior Conference Manager

**Joan Levy Zlotnik**, Consultant, Institute for the Advancement of Social Work Research

The many focus group participants whose thoughtful guidance assisted in the content planning and design of the National Child Welfare Evaluation Summit.

# CONFERENCE AT A GLANCE

## **TUESDAY, MAY 26**

---

5:00 P.M. – 7:00 P.M.      REGISTRATION

## **WEDNESDAY, MAY 27**

---

8:00 A.M. – 5:00 P.M.      REGISTRATION  
9:00 A.M. – 9:30 A.M.      WELCOME  
9:30 A.M. – 10:45 A.M.      OPENING PLENARY  
10:45 A.M. – 11:00 A.M.      BREAK  
11:00 A.M. – 12:30 P.M.      MODERATED PANEL DISCUSSIONS  
12:30 P.M. – 2:00 P.M.      LUNCH ON ONE'S OWN  
2:00 P.M. – 3:30 P.M.      WORKSHOPS  
3:30 P.M. – 3:45 P.M.      BREAK  
3:45 P.M. – 5:15 P.M.      PEER DISCUSSION GROUPS, EVALUATION TECHNICAL  
ASSISTANCE SESSION

## **THURSDAY, MAY 28**

---

8:00 A.M. – 5:00 P.M.      REGISTRATION  
8:00 A.M. – 10:00 A.M.      POSTER EXHIBIT SESSION & NETWORKING  
10:00 A.M. – 11:30 A.M.      WORKSHOPS  
11:30 A.M. – 1:00 P.M.      LUNCH ON ONE'S OWN  
1:00 A.M. – 2:30 P.M.      PLENARY  
2:30 P.M. – 2:45 P.M.      BREAK  
2:45 P.M. – 4:15 P.M.      MODERATED PANEL DISCUSSIONS  
4:15 P.M. – 4:30 P.M.      BREAK  
4:30 P.M. – 5:45 P.M.      AFFINITY GROUPS, EVALUATION TECHNICAL  
ASSISTANCE SESSION

## **FRIDAY, MAY 29**

---

8:00 A.M. – NOON              REGISTRATION  
9:00 A.M. – 10:30 A.M.      WORKSHOPS, PEER DISCUSSION GROUPS  
10:30 A.M. – 10:45 A.M.      BREAK  
10:45 A.M. – 11:45 A.M.      CLOSING PLENARY  
11:45 A.M. – NOON              CLOSING REMARKS

8:00 A.M. – 5:00 P.M.

**REGISTRATION**

9:00 – 9:30 A.M.

**WELCOME**

**Grand Ballroom**

Joseph J. Bock  
*Acting Associate Commissioner, Children's Bureau  
Administration for Children and Families (ACF)  
U.S. Department of Health and Human Services (DHHS)*

Krista Thomas, MSW  
*Child Welfare Program Specialist  
Region V, Children's Bureau, ACF, DHHS*

9:30 – 10:45 A.M.

**OPENING PLENARY: What is the State of Evaluation in Child Welfare?**

**Grand Ballroom**

This plenary will provide an overview of changes in child welfare evaluation over the past two decades, the evolution of evaluation in other social service fields, the challenges to evaluation for both state and tribal policy makers and academic and other evaluators, and the importance of partnerships between policy makers and evaluators in meeting those challenges.

Matthew W. Stagner, Ph.D.  
*Executive Director  
Chapin Hall at the University of Chicago*

Erwin McEwen, MSW  
*Director  
Illinois Department of Children and Family Services*

Sarah L. Hicks, Ph.D.  
*Director, Policy Research Center  
National Congress of American Indians*

10:45 – 11:00 A.M.

**BREAK**

11:00 A.M. – 12:30 P.M.

**MODERATED PANEL DISCUSSIONS**

**Panel #1: What is Sufficient Rigor in Child Welfare Evaluation When Attempting to Determine What Works?**

**Senate Room**

This dynamic panel will discuss the level of research rigor required for promotion of child welfare practices. This topic goes to the heart of evaluation practice in child welfare. Multiple perspectives on the question are represented on the panel, and we anticipate a lively discussion among panelists with opportunities for session participants to enter and guide the conversation as well. Come prepared to engage with others on this important topic.

Cathryn C. Potter, Ph.D. (Moderator)  
*Principal Investigator, Western Workforce Project  
National Child Welfare Workforce Institute Evaluation Team  
Mountains and Plains Implementation Center Evaluation Team  
Executive Director, Butler Institute for Families, University of Denver*

Jon Baron, J.D., MPA  
*President*  
*Coalition for Evidence-Based Policy*

Teresa Rafael, MSW  
*Executive Director*  
*National Alliance of Children's Trust and Prevention Funds*

Lisbeth (Lee) Schorr  
*Senior Fellow, Center for the Study of Social Policy*  
*Lecturer in Social Medicine, Harvard University*

Mark F. Testa, Ph.D.  
*Director, Children and Family Research Center*  
*Associate Professor, University of Illinois at Urbana-Champaign*

11:00 A.M. – 12:30 P.M.

**Panel #2: Evaluation Changes Posed by the Child Welfare Population**

**Pennsylvania**

Panel members will discuss how jurisdictions and evaluators are working through the unique challenges encountered in conducting evaluations with child welfare populations and within child welfare systems. Topics of discussion include identification, recruitment and long-term follow-up of study participants; ensuring participant protections; definitions of child maltreatment and utilization of administrative data; implementation of randomized control trials; and assessing the quality and fidelity of program implementation when child welfare staff must track information about activities and service provision.

Maria Woolverton (Moderator)  
*Senior Social Science Research Analyst*  
*Office of Planning, Research and Evaluation, ACF, DHHS*

Jonathan B. Kotch, M.D., MPH, FAAP  
*Principal Investigator, North Carolina local site, Longitudinal Studies Consortium on Child Abuse and Neglect*  
*Professor, UNC Gillings School of Global Public Health*  
*University of North Carolina at Chapel Hill*

Penelope L. Maza, Ph.D.  
*Consultant*  
*National Resource Center for Child Welfare Data & Technology*

Susan Mitchell-Herzfeld, M.A.  
*Director of Evaluation and Research*  
*New York State Office of Children & Families Services*

Christian Molidor, Ph.D.  
*Co-Principal Investigator, Child Welfare Comprehensive Workforce Grant*  
*Dean, School of Social Work, Louisiana State University*

**Panel #3: Defining and Evaluating Organizational and Systems Change**

**Georgia**

Organizational and systems change have taken on increased importance in the effort to improve permanency safety and well being for children and families. As child welfare administrations seek to make changes within organizations and across larger systems, evaluating the impact of their efforts is essential. This session will address the challenges in evaluating organizational/systems change. The panelists will answer critical questions regarding methodology, practical approaches to data collection, and the effective use of data to support the change process.

Raymond L. Crowel, Psy.D. (Moderator)  
*Vice President for Human Service Systems  
ICF International*

Karen A. Blase, Ph.D.  
*Senior Scientist  
National Implementation Research Network*

Crystal Collins-Camargo, MSW, Ph.D.  
*Director, National Quality Improvement Center on the  
Privatization of Child Welfare Services  
Assistant Professor, University of Louisville, Kent School of  
Social Work*

Paul Vincent, MSW, LCSW  
*Child Welfare Policy and Practice Group*

**Panel #4: Comparing the Level of Rigor in Child Welfare Evaluation to Other Fields**

**New Hampshire**

In the work toward building knowledge and identifying effective and promising practices in child welfare, we are faced with the question, what level of rigor is necessary to build evidence? This panel session will explore how various other fields have addressed this issue; what methods and results have they seen; what the child welfare field can learn from their experiences; and what evaluation lessons from other fields might not be easily applicable. Panelists will offer perspectives from various fields including: public health, education, mental health, child development and medical.

Larke Nahme Huang, Ph.D. (Moderator)  
*Senior Advisor on Children  
Office of the Administrator Substance Abuse and Mental Health  
Services Administration (SAMHSA), DHHS*

Bruno Anthony, Ph.D.  
*Director of Research and Evaluation  
Georgetown University Center for Child and Human  
Development*

Stephanie Chang, M.D., MPH  
*Center for Outcomes and Evidence  
Agency for Healthcare Research and Quality, DHHS*

Heather Koball, Ph.D.  
*Evaluation Design Task Leader*  
*National Cross-Site Evaluation of the Children's Bureau*  
*Evidence-Based Home Visitation Grant Program*  
*Senior Researcher, Mathematica Policy Research, Inc.*

Kathryn Newcomer, Ph.D.  
*Director, School of Public Policy and Public Administration*  
*George Washington University*

11:00 A.M. – 12:30 P.M.

**Panel #5: Conducting Culturally Appropriate Evaluations**

**Massachusetts**

This panel session will explore evaluation approaches with diverse and minority communities. Panelists will discuss how to create evaluation tools and methodologies to be culturally relevant and capture child welfare issues that particularly impact certain groups. A question and answer session will follow.

Krista Thomas, MSW (Moderator)  
*Child Welfare Program Specialist*  
*Region V, Children's Bureau, ACF, DHHS*

Dennette M. Derezotes, MSW, LCSW  
*Executive Director, Race Matters Consortium*  
*Senior Associate, Center for the Study of Social Policy*

Alan J. Dettlaff, Ph.D.  
*Assistant Professor, Jane Addams College of Social Work*  
*University of Illinois at Chicago*

Gerald P. Mallon, DSW  
*Professor and Executive Director, National Resource Center for*  
*Family Centered Practice and Permanency Planning*  
*Hunter College School of Social Work*

Paulette Running Wolf, Ph.D.  
*CFF Project Management Liaison*  
*Running Wolf & Associates*

**Panel #6: How Our Conceptualization of Change Shapes Evaluation Efforts**

**New York**

What theories guide evaluation in child welfare? How is our understanding of change in practice, organizations, and systems shaping our evaluation approaches? To what extent does/can complexity theory modify the form and function of process and outcome evaluations in child welfare? How do we measure (isolate) the impact of child welfare training (workforce development initiatives) upon child welfare outcomes? These are but a few of the questions that will be raised in this session.

Anita Barbee, MSSW, Ph.D. (Moderator)  
*Evaluator, Children's Bureau Training and Technical Assistance*  
*Network*  
*Evaluator on OFA Healthy Marriage Demonstration Project*  
*Evaluator on Children's Bureau Adoption Opportunities Project*  
*Professor and Distinguished University Scholar*  
*Kent School of Social Work, University of Louisville*

Glenda Eoyang, Ph.D.  
*Executive Director*  
*Human Systems Dynamics Institute*

Robin Perry, Ph.D.  
*Associate Professor*  
*Florida A&M University*

Fred Wulczyn, Ph.D.  
*Research Fellow*  
*Chapin Hall at the University of Chicago*

11:00 A.M. – 12:30 P.M

**Panel #7: Defining and Assessing Changes in Well Being**

**Rhode Island**

The child welfare field has focused on outcomes in the areas of safety, permanency and child well being. Yet among this triad, well being is perennially the weakest link. This panel will consider which aspects of child well being are important to judging the success of child welfare programs and how well-being can best be measured in and tailored to child welfare populations. Panelists will also discuss considerations in making appropriate comparisons on child well being measures.

Laura Radel, MPP (Moderator)  
*Senior Social Science Analyst*  
*Office of the Assistant Secretary for Planning and Evaluation,*  
*DHHS*

Mark E. Courtney, Ph.D.  
*Executive Director, Partners for Our Children*  
*University of Washington*

Raymond Kirk, Ph.D.  
*Principal Author and Developer of the North Carolina Family*  
*Assessment Scales*  
*Director, Division of Research and Program Evaluation*  
*Independent Living Resources, Inc., Durham, NC*

Cassandra Simmel, MSW, Ph.D.  
*Child Welfare Researcher*  
*Assistant Professor, School of Social Work, Rutgers University*

12:30 – 2:00 P.M.

**LUNCH**

2:00 – 3:30 P.M.

**WORKSHOPS**

2:00 – 3:30 P.M.

**Workshop #1: Understanding Evidence-Based Practice**

**Senate Room**

This session provides a quick overview of the development of the evidence-based practice movement and explores some of the key issues associated with a state or community shift to an evidence-based environment from setting the public policy context, to identifying implementing specific practices using Web-based resources such as the California Evidence-Based Clearinghouse for Child Welfare.

Stuart Oppenheim, M. Phil, MSW  
*Executive Director*  
*Child and Family Policy Institute of California*

Charles Wilson, MSSW  
*Executive Director, The Sam and Rose Stein Chair on Child  
Protection, Chadwick Center for Children and Families  
Rady Children's Hospital-San Diego*

2:00 – 3:30 P.M.

**Workshop #2: Choosing an Evaluation Approach – An  
Introduction to Design Alternatives for Your Evaluation**

**Virginia**

This workshop, targeted at new evaluators, program staff, and others exploring options for evaluating child welfare programs and services, provides an overview of the most common evaluation methodologies, including experimental, comparison group, and time series designs. The advantages and disadvantages of each approach are discussed, along with programmatic, organizational, resource, and other contextual factors to consider when selecting an evaluation approach. In addition, common myths regarding the various evaluation design alternatives are reviewed and critiqued.

Elliot Graham, Ph.D.  
*Director  
James Bell Associates*

Elyse Kaye, B.A.  
*Executive Vice President  
James Bell Associates*

**Workshop #3: Evaluating the Impact of Courts**

**Maryland**

The workshop will explore rigorous evaluations of dependency court reform efforts with a focus on Court Improvement Projects. Findings indicate that both dependency court reform and its evaluation are evolutionary. Presenters will highlight the challenges, strengths, and limitations to building knowledge and improving practice within the court system. This involves defining the responsibilities of the courts and child welfare agencies and how courts and agencies can achieve shared outcomes. A complementary discussion session (Discussion Session #3: Evaluating court improvement efforts) will follow.

Karl Ensign  
*Director, Evaluation for Children, Youth, and Families  
Planning and Learning Technologies, Inc.*

Gregory Halemba  
*Director of Applied Research  
National Center for Juvenile Justice*

**Workshop #4: Culturally Appropriate Evaluation**

**Pennsylvania**

When working cross culturally, it is important that evaluation activities are meaningful and relevant to the target population. This workshop will address the need for cultural competence in evaluation and provide strategies for adapting and/or creating evaluation tools and methodologies to ensure cultural sensitivity and cultural relevance in the evaluation of child welfare programs and services.

Alan Dettlaff, Ph.D.  
*Assistant Professor*  
*Jane Addams College of Social Work*  
*University of Illinois at Chicago*

Rowena Fong, Ed.D.  
*Member of the Texas Statewide Disproportionality Task Force*  
*and Austin Disproportionality Advisory Council*  
*The University of Texas at Austin*

2:00 – 3:30 P.M.

**Workshop #5: Identifying and Evaluating Primary Drivers of Change in Child Welfare Systems**

**Georgia**

One widely-held notion is that systems have drivers or leverage points, a concept that implies that investments in drivers will yield a rate of change in outcomes that is greater than it would otherwise be. In this session, the idea of system drivers will be explored with an emphasis on identifying drivers of change, designing change strategies that target drivers, and measuring whether investments that target drivers produce the expected results.

Fred Wulczyn, Ph.D.  
*Research Fellow*  
*Chapin Hall at the University of Chicago*

**Workshop #6: Successfully Using Randomized Controlled Trials in Child Welfare**

**Rhode Island**

This workshop reviews the use of randomized controlled trials (RCTs) in child welfare research and service demonstrations. It explains the strengths of randomization for drawing causal inferences about intervention effects. It examines key technical developments addressing problems that have hampered the use of RCTs, such as the estimation of intervention effects under incomplete treatment compliance, the prevention and analysis of attrition, and the ethical ramifications of denying treatment to subjects allocated to the control group.

Mark F. Testa, Ph.D.  
*Director, Children and Family Research Center*  
*Associate Professor, University of Illinois at Urbana-Champaign*

**Workshop #7: Rigorous Alternatives to Randomized Controlled Trials**

**Massachusetts**

Community-based evidence and practice-based evidence are two alternatives to randomized controlled trials. With lower costs, less time between research and applied results, and methodologies easier to implement on the ground, these research strategies hold great promise. Further, with community input, redundant design, and multiple data sources, these approaches are becoming more rigorous and easier for communities to implement. Applications of these methodologies in tribal communities will be shared as points for discussion and debate.

Sarah L. Hicks, Ph.D.  
*Director, Policy Research Center*  
*National Congress of American Indians*

Tribal communities have a long history of evaluation and research that has been badly undertaken and poorly received. The National Indian Child Welfare Association (NICWA), a Native-run organization, is well aware of the history of evaluation in Indian Country and has worked to develop an evaluation methodology and tool based on the Relational World View (RWV) that are respectful, participatory, and in keeping with Native traditions. The RWV has historically been applied to individual well-being and is usually associated with the medicine wheel or four directions teachings. Applied to the individual, the relational worldview sees life in terms of harmonious relationships; health or wellness is achieved by maintaining balance among the many interrelating factors in one's circle of life. NICWA applies the same concepts to the wellness of a child welfare system and uses the RWV to evaluate strengths and to pinpoint areas of intervention that are needed to restore balance. This methodology and tool will be presented at the workshop.

Kathleen Earle Fox, Ph.D.  
*Director of Research*  
*National Indian Child Welfare Association*

**Workshop #9: Rigorous Qualitative Methods****New Jersey**

This workshop will address the following questions: What should be the standard for rigor when using qualitative methods in child welfare evaluation? In what instances is a qualitative design preferable and arguably more appropriate for building evidence? What are some of the challenges and solutions when attempting to design and conduct a rigorous qualitative design? What are the strengths and limitations of qualitative approaches? Examples will be given from a variety of child welfare research and evaluation studies using both qualitative and mixed method designs.

Amy Chanmugam  
*Doctoral Student*  
*The University of Texas at Austin School of Social Work*

Ruth McRoy, Ph.D.  
*Evaluator, Collaboration to AdoptUsKids*  
*Research Professor*  
*The University of Texas at Austin, School of Social Work*

**Workshop #10: Evaluation of Policies and Statutes****New York**

This workshop will examine the planning and implementation processes for evaluating policies and statutes with specific discussion of the use of logic models and of meeting appropriate standards of evidence. The presenters will speak from the agency management perspective and from the evaluation research perspective. Both will use specific examples of experiences in addressing policy changes through the use of evaluation data and administrative data.

Larry Brown, MSW  
*Former Child Welfare Director, New York State  
Improving Outcomes for Children, Families and Communities*

Ying-Ying T. Yuan, Ph.D.  
*Partner  
Walter R. McDonald & Associates, Inc.*

2:00 – 3:30 P.M.

**Workshop #11: Economic Evaluation: Assessing Program Efficiency and Cost Effectiveness**

**South Carolina**

Economic evaluation refers to applied analytic methods used to identify, measure, value, and compare the costs and consequences of programs and interventions. This session provides an overview of these methods, including cost analysis, cost-effectiveness analysis (CEA), and benefit-cost analysis (BCA), with particular application to interventions to prevent child maltreatment

Phaedra S. Corso, Ph.D., MPA  
*Economic Evaluation Consultant, Family Connections and  
Evidence-Based Home Visitation Grants  
Associate Professor, University of Georgia, College of Public  
Health*

3:30 – 3:45 P.M.

**BREAK**

3:45 – 5:15 P.M.

**PEER DISCUSSION GROUPS AND EVALUATION TECHNICAL ASSISTANCE SESSION**

**Discussion #1: What is Sufficient Rigor When Attempting to Build Evidence?**

**Pennsylvania**

This session will focus on discussing the importance and usefulness of rigorous evaluation designs within the “real world” constraints of limited resources and time. Questions to be addressed include: What makes an evaluation rigorous? Is a rigorous evaluation the same as an informative evaluation? Is it better to pursue an evaluation that is not rigorous or to perform no evaluation at all?

Heather Koball, Ph.D.  
*Evaluation Design Task Leader, National Cross-Site Evaluation  
of the Children’s Bureau Evidence-Based Home Visitation Grant  
Program  
Senior Researcher, Mathematica Policy Research*

**Discussion #2: Overcoming Evaluation Challenges Posed by the Child Welfare System**

**Virginia**

This discussion group will offer participants an opportunity to discuss challenges and facilitators related to conducting an evaluation within a child welfare system. Potential topics will include involving parent voices in the evaluation process, limited opportunities to utilize an experimental design and the related ethical concerns, identifying measurable quality of service variables, and evaluating workload in the context of varying caseload standards and limited data. Alternative discussion questions will be considered based on the interests of the participants.

Cathy Sowell, LCSW  
*Evaluator, Florida’s Title IV-E Waiver Evaluation  
Social/Behavioral Researcher, University of South Florida*

Amy Vargo, M.A.  
*Principal Investigator, Florida's Title IV-E Waiver Evaluation*  
*Assistant in Research, University of South Florida*

3:45 – 5:15 P.M.

### **Discussion #3: Evaluating Court Improvement Efforts**

**Maryland**

This discussion session follows Workshop #3: Evaluating the Impact of Courts. A brief review of key points from the workshop will be shared. This session will offer an opportunity for open dialogue about the appropriate application of evaluation methodologies within court systems. Participants will share their questions and experiences in this area, and they will consider and discuss how rigorous and comprehensive current evaluation methods have been, what these evaluations have found, and where the evaluation field needs to move next in terms of developing knowledge about improved outcomes for children and families.

Karl Ensign  
*Director, Evaluation for Children, Youth, and Families*  
*Planning and Learning Technologies, Inc.*

### **Discussion #4: “Nuts & Bolts” of Culturally Appropriate Tribal Evaluations in Indian Country**

**Georgia**

The session will provide an opportunity for participants to share their successful experiences in conducting evaluations in Indian Country. Specifically, the session will focus on how to effectively partner with tribal communities to promote tribal ownership, utility, skills, in participating grant mandated evaluations. The session will rely on audience participation to capture “best practices” for conducting evaluations in Indian Country.

Paulette Running Wolf, Ph.D.  
*CFF Project Management Liaison*  
*Running Wolf & Associates*

### **Discussion #5: Involving Youth in the Evaluation Process: What Makes It Work?**

**New Hampshire**

Young people bring energy and enthusiasm to an evaluation project. They offer fresh perspectives and new insights into data collection and analysis. The reports about youth by youth are genuine and, ultimately, more interesting. This discussion will focus on what it takes to reap the benefits of youth involvement in evaluation — planning, methods, and standards. Come prepared to share your own experiences and ideas about engaging youth in assessment, research, and evaluation.

Dorothy I. Ansell, MSW  
*Program Director*  
*National Resource Center for Youth Development*  
*University of Oklahoma*

Ronna Cook, MSW  
*Consultant*  
*National Resource Center for Child Welfare Data & Technology*  
*Ronna Cook Associates, LLC*

**Discussion #6: A Continuing Discussion About Conducting Culturally Appropriate Evaluations**

**New Jersey**

This discussion session will continue with a more in-depth discussion about exploring evaluation approaches with diverse communities. Participants will be afforded opportunities to discuss how they have created evaluation tools and methodologies which are culturally relevant and capture child welfare issues that particularly impact certain groups. An active discussion and engaging conversation about culturally relevant evaluation in child welfare is expected and encouraged.

Gerald P. Mallon, DSW  
*Professor and Executive Director, National Resource Center for Family Centered Practice and Permanency Planning  
Hunter College School of Social Work*

**Discussion #7: Leveraging Resources Within Communities to Conduct Evaluation**

**Massachusetts**

This session provides the participants an opportunity to learn about developing resources for evaluation. Some of the areas that will be explored are: creating partnerships based upon common goals, identifying critical needs at critical times and soliciting in-kind contributions. Participants will be encouraged to share strategies that have been successful for them.

Donald Baumann, Ph.D.  
*Principle Investigator, Texas Disproportionality Evaluation  
Texas Department of Family and Protective Services and Saint Edwards University*

**Discussion #8: Building Capacity for Evaluation in Public Child Welfare Systems**

**New York**

As child welfare moves toward evaluation research and data-driven decision making, so does the need for building capacity in child welfare systems to effectively engage in these activities and translate knowledge into practice, program development and policy. Discussion topics include: State's child welfare systems organizational structures and processes developed for evaluation research; processes or methods used to determine the organizational structure and expertise to build capacity for evaluation research; use of planning models, participants, funding; evaluation research methods, types, designs; capacity and use of primary and secondary data, distinction and application of evaluation research, surveillance, quality assurance, administrative data; results dissemination; and sustainability of evaluation research.

Colleen Caron, Ph.D.  
*Assistant Director, Data and Evaluation  
Rhode Island Department of Children, Youth & Families  
Clinical Faculty Brown University*

**Discussion #9: Lessons From Performing Evaluation Under Federal Government Contracts and Grants**

**North Carolina**

This discussion group focuses on what has been learned by contractors and grantees that have conducted evaluations using Federal funds. Discussion questions will focus on the benefits and challenges presented by performing evaluation under Federal government contracts and grants; limitations and opportunities inherent in conducting evaluations using Federal funds; and identification of facilitators and barriers, as well as solutions to frequently encountered challenges.

Bethany D. Miller, M.Ed., MSW  
*Child Welfare Program Specialist*  
*Children's Bureau, ACF, DHHS*

**Discussion #10: Determining Which Programs and Services to Offer**

**South Carolina**

This facilitated discussion focuses upon the following questions: What methods (economic and otherwise) are child welfare administrators and community-based program directors using to make decisions about which programs and services they offer? What types of questions are being asked and what evidence is being used when deciding whether or not to include a program in a system's service array or a practice in an agency's service model?

Phaedra S. Corso, Ph.D., MPA  
*Economic Evaluation Consultant, Family Connections and Evidence-Based Home Visitation Grants*  
*Associate Professor, University of Georgia, College of Public Health*

Bowen McBeath, Ph.D., MSW  
*Assistant Professor of Social Work and Public Administration*  
*Portland State University*

**Discussion #11: The Role of Resources and Transparency in the Pursuit of Credible Evaluation and Evidence-Based Practice**

**Senate Room**

When assessing the credibility of "evidence" used to select evidence-based practices, most focus on evaluation design and interpretation of findings. This discussion will focus on the array of important factors to weigh in making such assessments. These may include the impact of having extensive financial resources to test a specific practice focused on a specific outcome; marketing and publicizing of evaluation findings; the relationship of the evaluator to the practice being evaluated; and the potential or real financial benefits for the developer or evaluator due to marketing of positive outcomes.

Penelope L. Maza, Ph.D.  
*Consultant*  
*National Resource Center for Child Welfare*  
*Data & Technology*

Joan Levy Zlotnik, Ph.D., ACSW  
*Executive Director*  
*Institute for the Advancement of Social Work Research*

3:45 – 5:15 P.M.

**Evaluation Technical Assistance Session # 1: Research Design,  
Logic Models, and Outputs and Outcomes**

*Rhode Island*

Need help with a real-life evaluation issue? Bring your questions and draft evaluation materials (e.g., evaluation plans and logic models) to this hands-on technical assistance session, which will give participants an opportunity to learn from their colleagues through one-on-one and small-group discussions guided by an experienced evaluator from James Bell Associates. Topics discussed through separate breakouts will include choosing a research design for your evaluation, building logic models, and quantifying outputs and outcomes. This session is open to all Summit participants.

Elliott Graham, Ph.D.  
*Director*  
*James Bell Associates*

Elyse Kaye, B.A.  
*Executive Vice President*  
*James Bell Associates*

8:00 A.M. – 5:00 P.M.

**REGISTRATION**

8:00 – 10:00 A.M.

**POSTER EXHIBIT SESSION & NETWORKING**

**Grand Ballroom**

10:00 – 11:30 A.M.

**WORKSHOPS**

**Workshop #12: Evaluating Organizational and Systems Change**

**Pennsylvania**

We, necessarily, make assumptions about new knowledge (innovation) and the dissemination or transfer thereof. Knowledge, we assume, is a pre-existing “it”, “thing” or commodity that is first made and then disseminated or transferred - like money. This workshop will challenge these assumptions by arguing reasons are not causes and more relevantly, research or knowledge is ultimately the product of the recipient, not a function of the source. Human agreement about what constitutes “value” is what ultimately creates knowledge, meaning, innovation or change.

David M. Introcaso, Ph.D.  
*Vice President*  
*Healthcare Research Marwood Group*

**Workshop #13: Using Federal Data Sources for Evaluation**

**Maryland**

The workshop will focus on Federal sources of secondary data that may be relevant for local evaluation research. Strategies for optimal use of case-level data and reports upon which they are based will be discussed. Several child welfare datasets housed at the National Data Archive on Child Abuse and Neglect will be highlighted, including the NCANDS, AFCARS, NSCAW, NIS, and LONGSCAN.

Elliot Smith, Ph.D.  
*Associate Director*  
*National Data Archive on Child Abuse and Neglect*  
*Cornell University*

**Workshop #14: Mining State Data to Answer Evaluation Questions**

**Virginia**

Beyond the Federal indicators, using administrative data creatively improves child welfare practice and program evaluation. This session focuses on using new proactive measures and program evaluation methodologies to encourage leaders and staff to think differently and improve CFSR performance and child welfare practice. We explore event history analytic techniques, merging administrative and provider data and creating models to trigger program improvement. We find blending proactive analytics and CQI techniques are powerful catalysts to improve results.

Ruth A. Huebner, Ph.D.  
*Child Welfare Researcher*  
*Kentucky Department for Community Based Services*

Roger Ward  
*Data Project Manager, Court Improvement Project*  
*Office of Children & Family, Ohio Department of Job & Family Services*

10:00 – 11:30 A.M.

**Workshop #15: Let's Get Real: Choosing Theory and Methodology in Evaluation**

**North Carolina**

This presentation will propose a framework for selecting evaluation approaches that yield actionable child welfare knowledge and build the evidence base for practice. The goal of this participatory workshop is to move the debate beyond false 'either / or' dichotomies and generate a theoretical frame for study designs that work inside the real constraints of child welfare evaluation.

Katharine Cahn, Ph.D., MSW  
*Executive Director, Child Welfare Partnership / Center for Improvement of Child & Family Services*  
*Portland State University School of Social Work*

**Workshop #16: Monitoring Child and Family Well-being: Conceptual and Data Resources**

**Georgia**

This workshop will cover national, state, and community resources for tracking child and family well being. It will also discuss potential uses for assessing need and evaluating progress in the child welfare field.

Brett Brown, Ph.D.  
*Vice President for Child and Family Studies*  
*Walter R. McDonald & Associates*

**Workshop #17: Demonstrating Effectiveness of Technical Assistance and Capacity-Building**

**New Hampshire**

The session will differentiate between training and technical assistance and how each affect capacity building at the individual, group, organizational and systems levels. Evaluation theory, methods and measures that apply to the evaluation of training will be described in some depth. The Children's Bureau's approach to training and technical assistance will be reviewed and the theory, methods and measures currently being used to evaluate the Children's Bureau T/TA Network and its effectiveness will be highlighted.

Anita Barbee, MSSW, Ph.D.  
*Evaluator, Children's Bureau Training and Technical Assistance Network*  
*Evaluator on OFA Healthy Marriage Demonstration Project*  
*Evaluator on Children's Bureau Adoption Opportunities Project*  
*Professor and Distinguished University Scholar*  
*Kent School of Social Work, University of Louisville*

James DeSantis, Ph.D.  
*Project Director, Cross-Site Evaluation of Children's Bureau's  
Child Welfare Technical Assistance Implementation Centers and  
National Child Welfare Resource Centers  
Vice President, James Bell Associates*

10:00 – 11:30 A.M.

**Workshop #18: Fostering State and Tribal Cooperation to  
Collect and Share Data**

**Senate Room**

When States and Tribes collaborate to collect and share data, they have the potential to improve child welfare practice with children and families. This workshop will consider evaluation questions in which States and Tribes share mutual interest and explore ways that collaboration can work and challenges can be overcome. Recently Oregon State DHS workers and Tribal communities held a State summit to explore and address issues of disproportionality in foster care among Native Americans in the State of Oregon. This panel will share the strategies and activities that were identified and developed to address the needs in Oregon.

Dottie Garcia, B.A.  
*Family Services Coordinator/Indian Child Welfare  
Confederated Tribes of Coos, Lower Umpqua & Siuslaw Indians*

Mary McNevins  
*Indian Child Welfare Manager  
State of Oregon Department of Human Services*

**Workshop #19: Using Evaluation to Address Disproportionality**

**Massachusetts**

This workshop will cover how Texas is using evaluation to address Disproportionality. A review of the Texas 79th legislature mandate, Statewide Disproportionality Taskforce, and Child Protective Services Disproportionality Specialist role will provide the context for the research design, implementation, and outcomes of the statewide evaluation of Disproportionality. A Decision-Making Ecology approach will be used to explain the impact of case, organizational and caseworker factors on disproportionate decisions. The intersection of race, poverty, and risk will be examples discussed as they relate to Disproportionality.

Donald Baumann, Ph.D.  
*Principle Investigator, Texas Disproportionality Evaluation  
Texas Department of Family and Protective Services and Saint  
Edwards University*

Rowena Fong, Ed.D.  
*Member of the Texas Statewide Disproportionality Task Force  
and Austin Disproportionality Advisory Council  
The University of Texas at Austin*

**Workshop #20: Evaluating Program Implementation: Tools for Assessing Process and Outcomes**

**New York**

Innovative programs of proven effectiveness are of little value in child welfare unless they are successfully implemented. This workshop reviews current issues in implementation research, including definitions and models of evidence-based practice (EBP) implementation, and offers practical advice on how to evaluate implementation process and outcomes. Attendees conducting similar efforts to evaluate implementation of innovative programs will receive consultation on evaluation designs and methods, drawing from ongoing studies of EBP implementation in child welfare settings.

Lawrence A. Palinkas, Ph.D.  
*Principal Investigator, Social Networks and EBP Implementation in Public Youth-Serving Systems*  
*Feldman Professor of Social Policy and Health, University of Southern California*

**Workshop #21: Evaluation When Scaling Evidence-Based and Promising Practices**

**South Carolina**

This workshop aims to develop participants' capacity to take evidence-based models to scale successfully. Through presentation of research and theory by addressing participants' concerns, the workshop will: familiarize participants with key challenges in taking evidence-based models to scale; introduce a framework for measuring fidelity and factors that influence it; identify strategies to promote fidelity; and explore opportunities to test the impact of these strategies on fidelity and on program impact.

Anne K. Duggan, Sc.D.  
*Private Investigator, Evaluation of Hawaii & New Jersey ACF Evidence-Based Home Visitation Grants*  
*Professor, Johns Hopkins University*

**Workshop #22: Evaluating Management and Financing Innovations**

**New Jersey**

This interactive workshop will provide an introduction to new managerial and fiscal innovations for improving the performance of child welfare systems, including privatization, performance contracting, and managed care. Methods for evaluating these innovations will be reviewed, with particular attention to identifying their impact on clients and service providers. The workshop will also introduce methods for implementing and evaluating other managerial initiatives such as performance management, six sigma, and learning organizational approaches.

Bowen McBeath, Ph.D., MSW  
*Assistant Professor of Social Work and Public Administration*  
*Portland State University*

**Workshop #23: Evaluation as an Intervention to Help You Achieve Results - Empowerment Evaluation**

*Rhode Island*

This session will demystify evaluation and accountability. The logic and tools of evaluation can help you plan systematically, implement with quality, and self-evaluate so that you can increase the probability of achieving outcomes. Empowerment evaluation is an approach to evaluation that incorporates this logic. This session will also describe the Getting To Outcomes® approach to results-based accountability that helps you achieve accountability by answering 10 accountability questions.

Abraham Wandersman, Ph.D  
*Professor, Department of Psychology  
University of South Carolina*

11:30 A.M. – 1:00 P.M. **LUNCH**

1:00 – 2:30 P.M.

**PLENARY: Challenges and Opportunities in Implementation and Change in Systems and Organizations**

*Grand Ballroom*

When implementing change in systems and organizations how do we better understand the process and outcomes of such efforts? What are the roles of systems, organizations, researchers, intervention developers, service providers, and community members? How can we foster collaboration among researchers, intervention developers, systems, and community members? What are some of the lessons learned about impacts of implementation on systems and organizations and the experiences of stakeholders in the implementation process, and where do we go from here?

Gregory A. Aarons, Ph.D.  
*Associate Professor of Psychiatry  
University of California, San Diego*

Kathy Simms, MSW  
*Child Welfare Consultant  
National Resource Center for Child Protective Services  
Former Oklahoma Child Welfare Administrator*

2:30 – 2:45 P.M. **BREAK**

2:45 – 4:15 P.M.

**MODERATED PANEL DISCUSSIONS**

**Panel #8: Lessons from Clearinghouses of Evidence, Strengths and Limitations**

*Pennsylvania*

This session will provide an overview from representatives of three national registries of evidence-based programs in these areas: child welfare, substance abuse and mental health, and education. Perspectives from a national technical assistance provider working with States who need to use these registries will also be shared. The latter part of the session will engage the audience in a discussion about several critical questions about the use of these national registries including: what have learned from clearinghouses and how are they used and understood by programs and funders; what are the strengths and limitations of using clearinghouses; and how can national registries be used effectively to transfer information and knowledge?

Melissa Lim Brodowski, MSW, MPH (Moderator)  
*Child Maltreatment Prevention Specialist*  
*Children's Bureau, ACF, DHHS*

Scott Cody  
*Deputy Director, The What Works Clearinghouse*  
*Senior Researcher, Mathematica Policy Research*

Kevin D. Hennessy, Ph.D.  
*National Registry of Evidence-Based and Promising Practices*  
*Office of Policy, Program and Budget, SAMHSA, DHHS*

Charles Wilson, MSSW  
*Executive Director, The Sam and Rose Stein Chair on Child*  
*Protection, Chadwick Center for Children and Families*  
*Rady Children's Hospital-San Diego*

Edi Winkle, MSW  
*Primary Author, Integrating Evidence-Based Practices into*  
*CBCAP Programs: A Tool for Critical Discussions*  
*Training/Technical Assistance Coordinator*  
*FRIENDS National Resource Center*

2:45 – 4:15 P.M.

**Panel #9: Evaluation Choices when Confronted with Scarce Resources**

**Georgia**

In times of scarce resources, does evaluation become more of a priority or is it seen as an unnecessary burden? Are there certain non-negotiable ingredients a useful evaluation must include? How do decision-makers weigh the costs and potential benefits of a proposed evaluation project? This panel of administrators and evaluators will reflect on the value of evaluation and the tough choices decision-makers and evaluators must make when faced with tight budgets and limited staff.

Michelle I. Graef, Ph.D. (Moderator)  
*Associate Director*  
*Midwest Child Welfare Implementation Center*  
*Research Associate Professor*  
*Center on Children, Families & the Law*  
*University of Nebraska-Lincoln*

Colleen Caron Ph.D.  
*Assistant Director, Data and Evaluation*  
*Rhode Island Department of Children, Youth & Families*  
*Clinical Faculty, Brown University*

Patrick Harrington, Ph.D.  
*Evaluator*  
*Contra Costa County, California*

Erwin McEwen, MSW  
*Director*  
*Illinois Department of Children and Family Services*

Joseph J. Walker  
*Evaluation Specialist*  
*Native American Training Institute*

This interactive session brings together a group of experienced evaluators to discuss lessons learned from national cross-site evaluations. The panel will discuss their approaches to cross-site evaluation, when it is most useful to conduct such an evaluation, some of the challenges, and ways that cross-site evaluation can contribute to local evaluations and program development. Audience members are encouraged to bring their experiences with and questions about cross-site evaluation to the discussion.

Christopher Botsko, M.A. (Moderator)  
*Early Childhood Comprehensive Systems Evaluation and  
 Technical Assistance  
 Altarum Institute*

Sharon Boles, Ph.D.  
*Performance Data Indicator Evaluation of the Regional  
 Partnership Grants, Children and Family Futures, Inc.*

Raymond L. Crowel, Psy.D.  
*Cross-Site Evaluation of Child Welfare Systems of Care Sites  
 Vice President for Human Service Systems, ICF International*

James DeSantis, Ph.D.  
*Project Director, Cross-Site Evaluation of Children's  
 Bureau's Child Welfare Technical Assistance Implementation  
 Centers and National Child Welfare Resource Centers  
 Vice President, James Bell Associates*

Brigitte A. Manteuffel, Ph.D.  
*Principal Investigator, National Evaluation of the Comprehensive  
 Community Mental Health Services for Children and Their  
 Families Program  
 Vice President, ICF Macro*

**Panel #11: Evaluation of Workforce Practices****Massachusetts**

Questions to the panelists will focus on workforce interventions. Interventions: What are the factors that affect workforce recruitment, retention and performance? What still needs to be done in terms of the interventions we should be testing? Methodology: What are the pros and cons of using an experimental design; what's possible in workforce related evaluations? Instrumentation/measurement: What instruments have been used to measure effectiveness of interventions, and what other instruments/measures might be explored?

Pamela Day, MSW (Moderator)  
*Co-Director, Child Welfare Information Gateway  
 Senior Project Manager, ICF International*

Nancy Dickinson, Ph.D.  
*Project Director, National Child Welfare Workforce Institute  
 Jordan Institute for Families  
 University of North Carolina School of Social Work*

Alberta J. Ellett, Ph.D.  
*Principal Investigator of Title IV-E Child Welfare Education & Retention & Turnover Study*  
*Associate Professor*  
*University of Georgia, School of Social Work*

Cathryn C. Potter, Ph.D.  
*Principal Investigator, Western Workforce Project*  
*National Child Welfare Workforce Institute Evaluation Team*  
*Mountains and Plains Implementation Center Evaluation Team*  
*Executive Director, Butler Institute for Families, University of Denver*

2:45 – 4:15 P.M.

**Panel #12: Translating Dissemination and Implementation Research into Practice**

**Senate Room**

Panelists will address the following questions and others posed by participants: What have dissemination and implementation research and evaluation taught us about the effectiveness of strategies intended to promote awareness, comprehension, retention, adoption, and implementation? What methods of knowledge transfer and implementation have been demonstrated to be most effective and in what contexts? What models for knowledge transfer have been demonstrated to be effective in child welfare systems? How much evidence do we have that these methods/models work?

Jack Denniston (Moderator)  
*Child Welfare Program Specialist*  
*Children's Bureau, ICF International*

Diane DePanfilis, MSW, Ph.D.  
*Professor, Associate Dean for Research*  
*Director, Ruth H. Young Center for Families and Children*  
*University of Maryland School of Social Work*

David M. Introcaso, Ph.D.  
*Vice President*  
*Healthcare Research Marwood Group*

Abraham Wandersman, Ph.D.  
*Professor, Department of Psychology*  
*University of South Carolina*

**Panel #13: Evaluating Technical Assistance to Child Welfare Systems**

**New Jersey**

Panelists will explore the issues and challenges involved in developing and implementing evaluations of technical assistance activities and systems. Among the key questions panelists will address are: How do we define "technical assistance" and the outcomes it is designed to accomplish? How do we develop conceptual frameworks for technical assistance initiatives or systems that help structure evaluation approaches? What are some of the critical data collection strategies and challenges?

Peter Watson, Ph.D. (Moderator)  
*Director*  
*National Resource Center for Organizational Improvement*  
*Muskie School, University of Southern Maine*

Elizabeth Caron, Ph.D.  
*Education Program Specialist*  
*Office of Special Education Programs*  
*U.S. Department of Education*

Raymond Kirk, Ph.D.  
*External Evaluator of the National Resource Center for*  
*Community-Based Child Abuse Prevention*  
*Director, Division of Research and Program Evaluation*  
*Independent Living Resources, Inc., Durham, NC*

Ruth McRoy, Ph.D.  
*Evaluator, Collaboration to AdoptUsKids*  
*Research Professor*  
*The University of Texas at Austin, School of Social Work*

Joan Smith, MBA  
*Senior Director, Systems Improvement Services*  
*Casey Family Programs*

2:45 – 4:15 P.M.

**Panel #14: Ethical Issues and Evaluation in Child Welfare**

**New York**

Participants will explore a number of the unique ethical issues associated with research and evaluation in the field of child welfare, including: the risks and benefits associated with “program evaluation” versus “research,” ethical challenges in research and evaluation with public child welfare agency populations and tribal communities, and the role cultural differences play in evaluation planning, implementation, and interpretation of findings.

Mary Bruce Webb, Ph.D. (Moderator)  
*Director, Division of Child and Family Development*  
*Office of Planning, Research and Evaluation, ACF, DHHS*

Kathryn Dowd, MPPA  
*Project Director*  
*National Study of Child and Adolescent Well-Being*  
*Research Triangle Institute International*

Kathleen Earle Fox, Ph.D.  
*Director of Research*  
*National Indian Child Welfare Association*

Desmond Runyan, M.D., Dr.PH.  
*Principal Investigator*  
*Longitudinal Studies in Child Abuse and Neglect*  
*Professor of Social Medicine, University of North Carolina*

**Panel #15: Creating Partnerships for Evaluation**

**Rhode Island**

Partnerships are critical to building and sustaining a research and evaluation enterprise. This session will examine how agencies and other entities (universities, institutes, organizations, foundations, etc.) partner to conduct research. Speakers will examine the impetus for creating such partnerships, strategies for funding and sustainability, and the importance of monitoring and evaluating the partnerships itself. Specific successes and lessons learned will be addressed, with emphasis on the value of university/agency partnerships for implementing research and evaluation.

Joan Levy Zlotnik, Ph.D., ACSW (Moderator)  
*Executive Director*  
*Institute for the Advancement of Social Work Research*

Mary I. Armstrong, Ph.D.  
*Co-Principal Investigator, Evaluation of Florida's IV-E Waiver*  
*Assistant Professor, University of South Florida*

Katharine Cahn, Ph.D., MSW  
*Executive Director, Child Welfare Partnership / Center for*  
*Improvement of Child & Family Services*  
*Portland State University School of Social Work*

Barrett Johnson, MSW, LCSW  
*Director, Child Welfare In-Service Training Project*  
*California Social Work Education Center*  
*University of California, Berkeley, School of Social Welfare*

Susan Mitchell-Herzfeld, M.A.  
*Director of Evaluation and Research*  
*New York State Office of Children & Families Services*

4:15 – 4:30 P.M.

BREAK

4:30 – 5:45 P.M.

**AFFINITY GROUPS AND EVALUATION TECHNICAL ASSISTANCE SESSION**

Affinity group sessions are focused on specific practice or programmatic areas, and are less structured than other Evaluation Summit sessions. Guided by facilitators, affinity groups provide participants an opportunity to exchange information on a topic area, discuss common concerns, problem-solve, and network with peers.

<b>Child Welfare Workforce Training/Recruitment/Retention</b>	<b><i>Pennsylvania</i></b>
<b>Adoption and Post-Adoption Outcomes</b>	<b><i>Virginia</i></b>
<b>Permanency</b>	<b><i>Maryland</i></b>
<b>Child Protection</b>	<b><i>Georgia</i></b>
<b>Family Preservation and Child Abuse/Neglect Prevention</b>	<b><i>New Hampshire</i></b>
<b>Systems of Care</b>	<b><i>New Jersey</i></b>
<b>Administrative Data Sets</b>	<b><i>Massachusetts</i></b>
<b>Culturally Appropriate Evaluation with Tribes</b>	<b><i>South Carolina</i></b>
<b>Evaluation with Limited Funding and Resources</b>	<b><i>North Carolina</i></b>
<b>Randomized Controlled Trials (RCT) vs. Other Evaluation Methodologies</b>	<b><i>New York</i></b>
<b>Evaluation of Well-being</b>	<b><i>Senate Room</i></b>
<b>Independent Living/Older Youth Evaluations</b>	<b><i>Rhode Island</i></b>

**Evaluation Technical Assistance Session # 2: Child Welfare  
Evaluation Resources: What We Have and What We Need**

**Grand Ballroom**

This session will begin with an overview of evaluation resources that are currently available and relevant to the child welfare field. Discussion questions are intended to identify: potential changes, additions, and revisions that may improve upon existing resources; barriers to using existing resources; and gaps in existing resources in the arena of child welfare evaluation. Information from the discussion will be used to inform the accessibility and revision of existing resources, and the development of new resources.

Kathleen M. Dwyer, Ph.D.  
*Society for Research in Child Development Executive Branch  
Policy Fellow  
Office of Planning, Research, and Evaluation, ACF, DHHS*

Elliot Graham, Ph.D.  
*Director  
James Bell Associates*

Elyse Kaye, B.A.  
*Executive Vice President  
James Bell Associates*

Matthew McGuire, M.A.  
*Child Welfare Program Specialist Children's Bureau  
Child Welfare Information Gateway*

Elizabeth Mertinko, MSW  
*Program Support Manager, Children's Bureau  
Child Welfare Information Gateway*

Edi Winkle, MSW  
*Primary Author, Integrating Evidence-Based Practices into  
CBCAP Programs: A Tool for Critical Discussions  
Training/Technical Assistance Coordinator  
FRIENDS National Resource Center*

8:00 A.M. – NOON

**REGISTRATION**

9:00 – 10:30 A.M.

**WORKSHOPS**

**Workshop #24: Community-Based and Participatory Evaluation**

**Pennsylvania**

This workshop will provide an overview of community-based participatory evaluation including guiding principles, different approaches to design and methods, and examples from projects in Detroit with African American and Latino populations in Detroit. The workshop is particularly relevant for community-university partnerships and will include implications for evaluation in child welfare.

Michael S. Spencer, Ph.D., LMSW  
*Associate Professor*  
*University of Michigan, School of Social Work*

**Workshop #25: Evaluation with Workload Analyses and Resource Allocation**

**Georgia**

Any evaluation of child welfare practice should be sensitive to the influence of workforce issues and resources available to maximize the likelihood of desired outcomes. This workshop will examine prevailing knowledge (and evaluation models) on these two issues and explore (via the summarization of findings from two studies): 1) the positive impact that a rigorous and integrated task analysis study can have upon streamlining service delivery models and maximizing outcomes; and, 2) the need for detailed resource allocation models that are guided by principles of equity and adequacy. Discussion will expand into the role and influence that econometrics, flow models, and stock adjustment models may have for child welfare evaluation.

Robin Perry, Ph.D.  
*Associate Professor*  
*Florida A&M University*

**Workshop #26: Training Evaluation: Methods to Measure Change in Comprehension and Retention of Information**

**Massachusetts**

The human services field has begun to explore training and professional development strategies for facilitating the application of knowledge and skills to the job. However, there are very few studies that effectively measure transfer of learning as an outcome in child welfare. This workshop will explore methodology for assessing TOL and address the following questions: What evaluation methods are being used to measure changes in comprehension and retention of information among child welfare professionals? What are the pros and cons of different methods?

Robin Leake, Ph.D.  
*Research Manager, Butler Institute for Families,*  
*University of Denver*

Cynthia Parry, Ph.D.  
*Independent Consultant*  
*CF Parry Associates*

9:00 – 10:30 A.M.

**Workshop #27: Systems Change: Thinking and Doing**

**New Hampshire**

Systems change is a noble mission, but what does it mean to our work in child welfare and evaluation? This interactive session describes a range of systems approaches and responds to relevant questions, including: What is a system? What tools and methods support systems thinking and doing? How can human systems dynamics inform evaluation design and implementation? When and how can you apply systems thinking to your change and evaluation efforts?

Glenda Eoyang, Ph.D.  
*Executive Director*  
*Human Systems Dynamics Institute*

**Workshop #28: Evaluating the Effectiveness of Information Management and Technology in Knowledge Transfer**

**New Jersey**

Presenters will address the following questions and others posed by participants. What are the indicators and outcomes of effective information/knowledge management? What methods are being used to evaluate the effectiveness of information management (including whether information has been organized and presented in a way that results in greater accessibility and utilization)? What are the indicators and outcomes of effective knowledge transfer? What methods are being used to assess the effectiveness of technology in knowledge transfer? What are the strengths and limitations of current practice?

Kim Pawley Helfgott  
*Child Welfare Resource Specialist*  
*Technical Assistance Partnership for Child and Family Mental Health*

Kate Walser, MBA, Certified Usability Analyst  
*Former Director, Usability Center of Excellence and Knowledge Management Center of Excellence*  
*Principal and Senior User Experience Designer*  
*CX Insights, a Division of Tritus Technologies, Inc.*

Mark Youman, PMP  
*Principal*  
*ICF International*

9:00 – 10:30 A.M.

**Workshop #29: Evaluating Practice Models**

**Senate Room**

In recent years, child welfare agencies have tried to improve practice and make it more consistent through the implementation of distinct models of practice. Considerable challenges face child welfare agencies seeking to evaluate the success of these interventions in improving outcomes for children and families. This session will describe an ongoing evaluation of the Solution-Based Casework practice model and use the evaluation to illustrate issues that arise in evaluating practice models.

Mark E. Courtney, Ph.D.  
*Executive Director, Partners for Our Children  
University of Washington*

**Workshop #30: Applying Logic Models in Plans for Systemic Change and Evaluation**

**New York**

The purpose of this workshop is to support participants to develop logic models to guide and evaluate systemic change in child welfare. Following brief definitions, participants will consider logic model examples for Tribal and state child welfare systems that will illustrate the implementation of change strategies designed to lead to improved child safety, permanency, and/or well-being outcomes. Simple mechanisms for tracking and reporting on activities, outputs, organizational outcomes, and child/family outcomes will be discussed.

Diane DePanfilis, MSW, Ph.D.  
*Professor, Associate Dean for Research  
Director, Ruth H. Young Center for Families and Children  
University of Maryland School of Social Work*

Carolyn M. White, MSW, LCSW  
*Family Services Executive Director  
Poarch Band of Creek Indians*

9:00 – 10:30 A.M.

**PEER DISCUSSION GROUPS**

**Discussion #12: Considering Fidelity and Adaptation in Implementation**

**South Carolina**

This session will offer participants an opportunity to discuss issues such as (1) factors to consider when weighing the importance of fidelity to a program model against appropriate adaptations to the context and population being evaluated; (2) the implications of the tension between model fidelity and adaptation for designing an evaluation; and (3) how evaluators have addressed model adaptations and midstream practice changes when trying to build evidence for effective programs and practices.

Jill Filene, MPH  
*Project Director, National Cross-Site Evaluation of the Replication of  
Demonstrated Effective Prevention Programs (Family Connections)  
Senior Research Associate, James Bell Associates*

**Discussion #13: Potential Evaluation in Tribal Child Welfare Programs**

**Virginia**

Federal title IV-B allocations are used by Tribes to help fund their child welfare programs. Recently enacted legislation provides an opportunity for Tribes to expand their child welfare services and systems with the use of title IV-E funds. Developing or expanding Tribal child welfare depends on solid infrastructure and the evaluation process that informs successful programs.

Gail E. Collins, MPA  
*Director, Division of Program Implementation  
Children's Bureau, ACF, DHHS*

Kathy Deserly  
*Child Welfare Specialist and Consultant  
Indian Child and Family Resource Center*

Joseph J. Walker  
*Evaluation Specialist  
Native American Training Institute*

**Discussion #14: Providing a Context to Examine Racial and Ethnic Disproportionality and Disparities in Systems Efforts**

**Rhode Island**

A great deal of information about research, data and program evaluation within the context of race and ethnicity has been presented heretofore. How can system efforts best be organized to integrate race and ethnicity in agency efforts? This discussion group will begin with a short presentation of a context that can be used to organize different aspects of integrating race into agency systems work. Participants will then be invited to present their strategies, barriers and questions for group discussion.

Dennette M. Derezotes, MSW, LCSW  
*Executive Director, Race Matters Consortium  
Senior Associate, Center for the Study of Social Policy*

**Discussion #15: Using Evaluation to Communicate with Legislators**

**North Carolina**

This guided discussion group will cover when and how to use evaluation results to communicate with legislators about key priorities in child welfare reform. State child welfare agency administrators are invited to attend to share their experience communicating evaluation findings with legislators, including the fiscal and budgetary effects of evaluation results. The session leader will share examples from states and discuss how to provide legislative audiences with a long-term child welfare reform context for evaluation findings.

Nina Williams-Mbengue, B.A.  
*Program Director, Child Welfare Project  
National Conference of State Legislatures*

9:00 – 10:30 A.M.

**Discussion #16: Monitoring Child and Family Well-Being:  
Conceptual and Data Resources National Data Sources**

The discussion will build on the "Using Federal data sources for evaluation" workshop. Evaluators will have the opportunity to describe their particular needs and brainstorm with the group how existing data may inform their research designs and refine their hypotheses.

Elliot Smith, Ph.D.  
*Research Associate  
Cornell University*

10:30 – 10:45 A.M.

**BREAK**

10:45 – 11:45 A.M.

**CLOSING PLENARY: What Lies in the Future for Evaluation in the  
Field of Child Welfare?**

**Grand Ballroom**

The future of child welfare evaluation must address longstanding limitations by building on existing strengths and drawing from other fields that have identified advances in the provision of cost-effective ways to complete meaningful evaluations. These tools include more innovative designs and more comprehensive analyses. The critical need for better child welfare evaluation will be best met if the field experiences reinvestment in the education and support of evaluators and the dependable provision of substantial evaluation opportunities.

Richard P. Barth, Ph.D.  
*Professor and Dean, University of Maryland Baltimore  
Co-Investigator, Atlantic Coast Child Welfare Implementation  
Center*

11:45 A.M. – NOON

**CLOSING REMARKS**

Joseph J. Bock  
*Acting Associate Commissioner  
Children's Bureau, ACF, DHHS*

NOON

**ADJOURN**

# HOTEL MAP

## LOBBY LEVEL

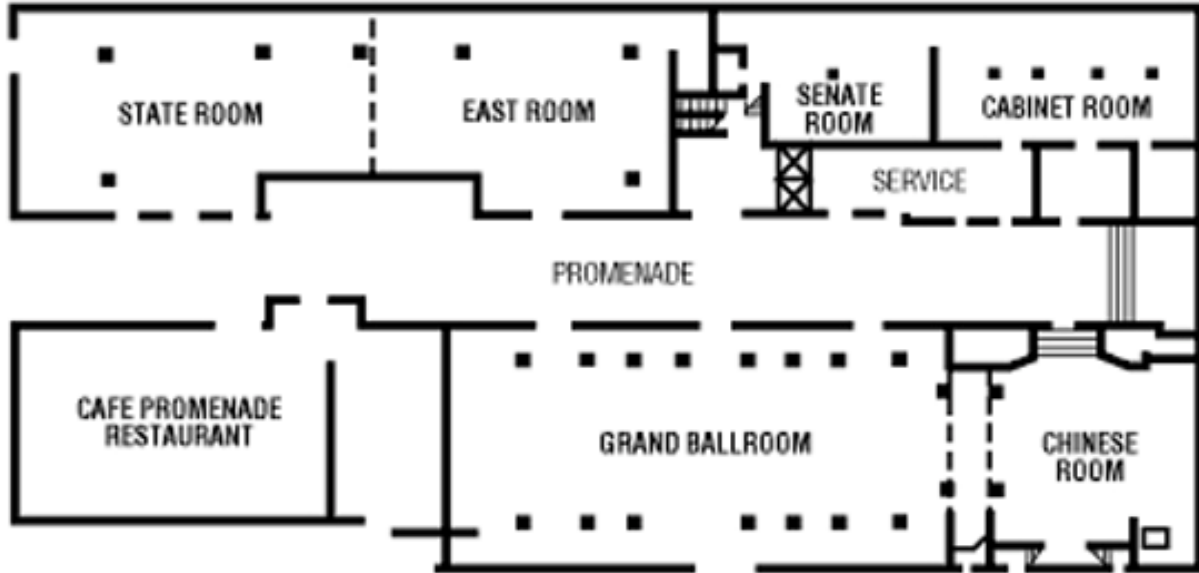

## SECOND FLOOR

